



WESTLAKE

Project: \_\_\_\_\_

Model: \_\_\_\_\_ Series #: \_\_\_\_\_

Dealer: \_\_\_\_\_ Quantity#: \_\_\_\_\_

Delivery address: \_\_\_\_\_ Date: \_\_\_\_\_

## 2 Glass Door Refrigerator Merchandiser

Model#WKR-48G



### Features

- Precision ventilated refrigeration system keeps food at safe temperature
- Electronic control system make it easy to adjust temperature set point and defrost frequency
- Self Closing glass doors,locks and keys included
- Preinstalled heavy duty casters with brakes
- Removeable installation board makes it easy to access condenser coil for cleaning and service
- Painted steel exterior and interior,ensure longer life
- Full lighting vertical LED light,separated switch controls
- Anti-corrosion coated coil evaporator,ensure 10 years life of westlake products
- 8 epoxy coated steel wire shelves,90 lbs loading capacity each
- R290 hydro carbon refrigerant that has zero(0) ozone depletion potential(ODP)&three(3)global warming potential(GWP)

### WARRANTY:

- 2 Years Parts and Labor
- 6 Years compressor (Additional 4 years parts only)
- westlake is responsible for components failure. but is not responsible for improper operation failure and artificial damage.



Parts & Labor



Compressor





# 2 Glass Door Refrigerator Merchandiser

Model#WKR-48G

## TECHNICAL DATA

Model	WKR-48G
Temperature range	33°F~41°F
Refrigerant	R290
Max Ambient Temperature	86°F
Defrosting	Automated Defrost
Horsepower	1/5P
Exterior Dimension(WxDxH) inch	48*27.2*80.7
Interior Dimension(WxDxH) inch	44.5*20.9*52
Gross Weight(lb)	363
Net Weight(lb)	310
Packing Dimension(WxDxH) inch	51.2*31.3*84.6
Voltage/Phase/Hz	115V/1/60Hz
Amps	3.6A
Electrical Cord Length	59 inches

## PLAN VIEW

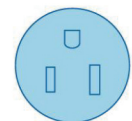
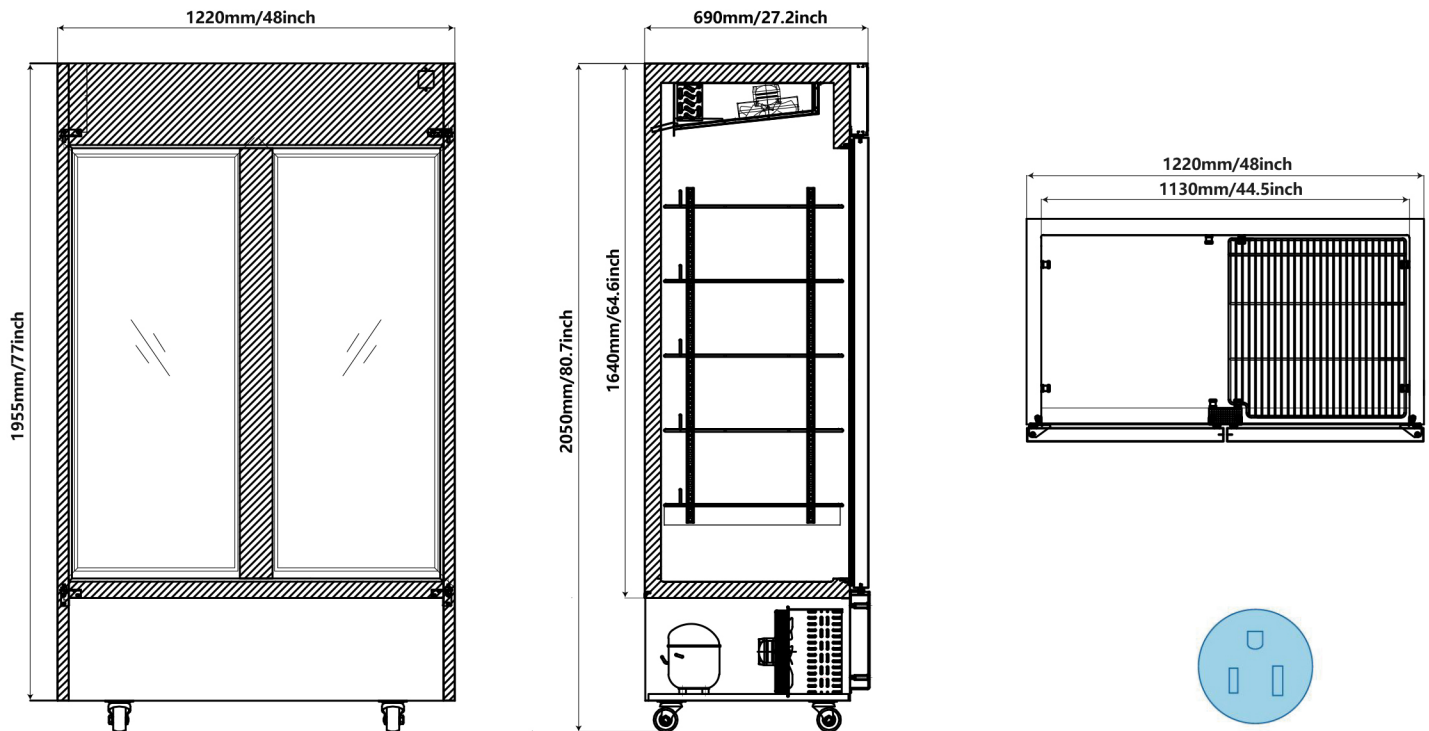

NEMA 5-15P